

40A Disconnect Switch

UL File # E245542

40A Disconnect Switch



Description	Part #	List Price
40A General Purpose w/ (11.8") Shaft and "4 screw" Handle	40A-MINI-**	\$91.00
40A Switch Only	40A-MINI	\$47.00

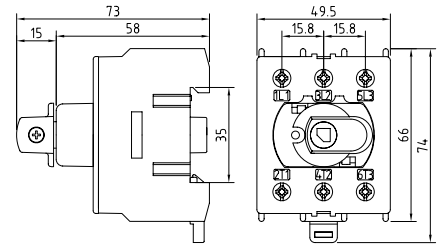

	120V	208V	230V	460V	600V
Single Phase	2	5			
Three Phase		7.5	10	20	15

**	Description
-RG	Red / Yellow Handle
-SS	Black Handle

UL508

Shaft



Enclosure depth 13" Max, 3" Min.

Part # CC - SHAFT
List \$19

Handle Options

Padlockable NEMA 4X, up to 3 padlocks. (Safety Door Interlock)

<p>22mm Single Hole Mount Design Part # CC - SH - SS List \$29</p>	<p>4 Screw Mount Design Part # CC - SS List \$25</p>
<p>Part # CC - SH - RG List \$29</p>	<p>Part # CC - RG List \$25</p>

Auxilliary Contact





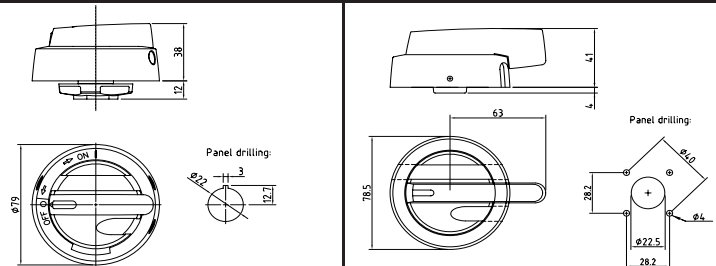

1 N.O. / 1 N.C.
Rated 16A form "C"

Part # AUX-KUIV
List \$29



Non Fusible Disconnects (4X)

	General Purpose Amps	Horsepower Rating / HP		Handle Color	Part Number	List Each	Dimensions mm/in			
		1 Phase	3 Phase				H	W	D	
	25A	110-120V AC	1	-	Red / Yellow	25A - 3P - RG - 4X	\$124	118	96.4	106
		208V AC	2	5						
		220-240V AC	3	7.5						
		277V AC	3	7.5	Black	25A - 3P - SS - 4X				
		380-415V AC	-	10						
		440-480V AC	-	15						
550-600V AC	-	10								
	40A	110-120V AC	2	-	Red / Yellow	40A - 3P - RG - 4X	\$204	190	145	131
		208V AC	3	7.5						
		220-240V AC	5	10						
		277V AC	5	10	Black	40A - 3P - SS - 4X				
		380-415V AC	-	15						
		440-480V AC	-	20						
550-600V AC	-	15								
	60A	110-120V AC	3	-	Red / Yellow	60A - 3P - RG - 4X	\$225	190	145	131
		208V AC	5	10						
		220-240V AC	5	10						
		277V AC	7.5	10	Black	60A - 3P - SS - 4X				
		380-415V AC	-	20						
		440-480V AC	-	25						
550-600V AC	-	25								
	80A	110-120V AC	3	-	Red / Yellow	80A - 3P - RG - 4X	\$320	190	145	131
		208V AC	7.5	15						
		220-240V AC	7.5	15						
		277V AC	10	20	Black	80A - 3P - SS - 4X				
		380-415V AC	-	25						
		440-480V AC	-	30						
550-600V AC	-	40								

▲ Contact Factory: For larger sizes. Also available are Stainless steel Enclosed version.

	<p>If auxiliaries are desired (1 N.O. / 1 N.C.) , add suffix - "AX" to any of the above part numbers (+\$29 list). (Rated 16A form "C")</p> <p>Example: 40A-3P-RG-4X-AX \$233 List</p>
---	--